

TTM-C30 SERIES

■ FEATURES

- COMPACT BODY (Dimension: 76 X 34mm)
- BLUE LED COLOR DISPLAY FOR CLEAR VISIBILITY.
- 3-POINT EXTENSIVE OUTPUT (Defrost Function Output, Compressor Control Output, Fan Control Output)
- EQUIPPED WITH MONITORING FUNCTION (Anomalous Occurrence, Built-in Safety Circuit)
- BROAD RANGE TEMPERATURE SETTING INDICATION RANGE (−40.0°C to +99.9°C)
- INCLUSIVE OF 1 PC. THERMISTOR SENSOR
- CE-MARKING (application pending), ROHS COMPLIANT



■ BASIC SPECIFICATION

- Panel Cut-Size: 70 x 28 mm
- External Dimension: 76 x 34 mm
- Measuring Range: −40.0°C to +99.9°C
- Input Type: Thermistor Input (Model: CWFT0103FA243)
- Display Accuracy: 0.1°C
- Output Type: 3 Relay Contact Output (AC250V/2A) (Comp. / Defrost / Fan)
- Control Method: ON/OFF
- Power Supply: AC100±10% or AC220V±10% (50/60Hz) (Select one)
- Power Supply: AC100±10% or AC220V±10% (50/60Hz) (Select one)
- Usage Environment: : 0 to 55°C, 20 to 80%RH (provided no condensation)

■ TERMINAL CONNECTION

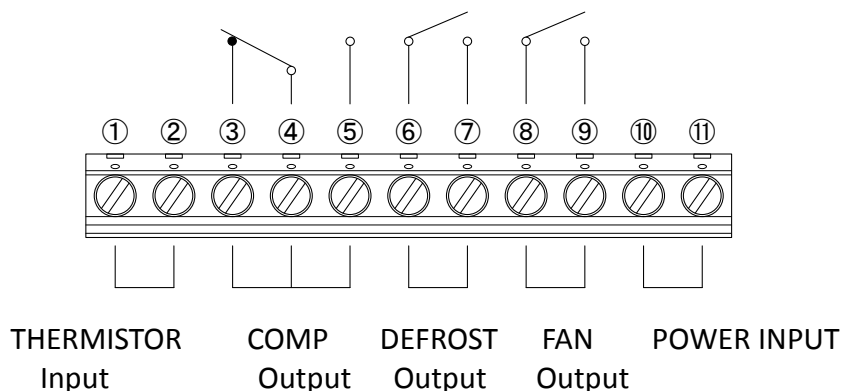

■ PANEL-CUT & EXTERNAL DIMENSION

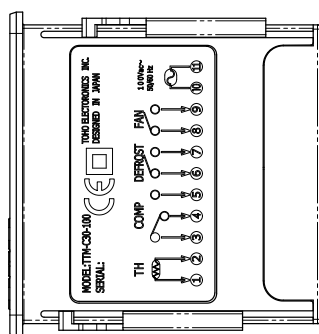
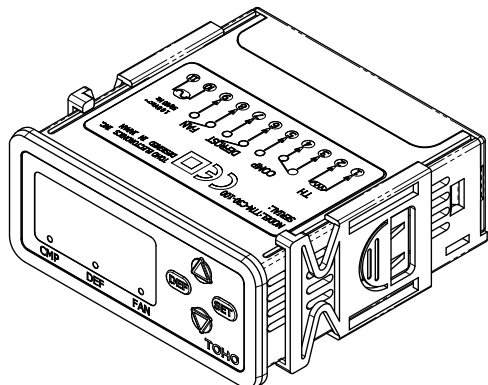

**INCLUSIVE OF 1 PC.
THERMISTOR SENSOR**

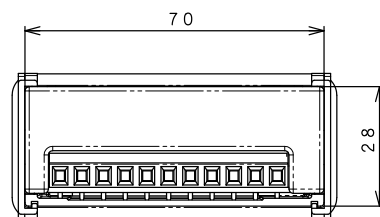
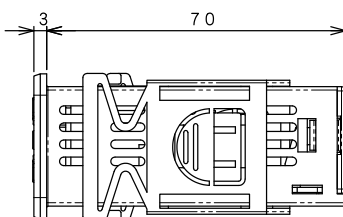
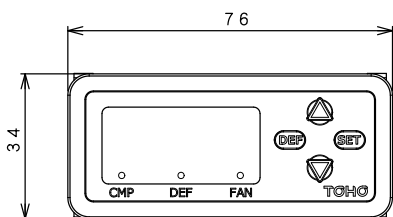

■ MODEL SELECTION

TTM — C30 —

①

ITEM	MARK	CONTENT
① Power Specification	100	AC100V ± 10% (50/60Hz)
	220	AC220V ± 10% (50/60Hz)

 **TOHO ELECTRONICS INC.**



WARNING

This product was designed with the purpose of controlling temperature of the general industrial equipment as well as other physical quantities. Do not use this product to control anything that will greatly affect the human life.



CAUTION

Kindly read the instruction manual thoroughly in order to use this product properly and safely. If there are risk of injuries or damages that may be inflicted on the system or property, apply safety precaution for the failure prevention measure when using this product.

Head Office:

**2-4-3 Nishihashimoto, Midori-Ku, Sagami-hara-Shi,
Kanagawa-Ken 252-0131 JAPAN**

TEL.: +81-42-700-2100, FAX.: +81-42-700-2112

e-mail: overseas@toho-inc.co.jp

Website: <http://www.toho-inc.com/English/index.html>