

## Đèn hiệu xoay

SK

New



Φ 80 mm	Φ 100 mm	Φ 150 mm	CE	RoHS 10	UL
FCC	ICES	KC	EAC	PSE	IP23
Indoor/Outdoor Use	Upright/Sideways*/Inverted Mounting	Ambient Temperature: -10% ~ -50%	Red, Amber, Green, Blue	Motorized Rotation	88dB

\*Indoor only



SKS: Φ80mm

SKH: Φ100mm

SKP: Φ150mm

With buzzer

☑ Use the optional rubber gasket to increase the IP rating from

IP23 to IP65. (SKS, SKH only)

## Sơ đồ chọn mã

## SKH-M1JB-R

① ② ③ ④

① Kích thước  
S = Φ80mm  
H = Φ100mm  
P = Φ150mm

② Điện áp / Đầu nối  
M1J = 12 - 24V DC / cáp  
MIT = 12 - 24V DC / khối terminal\*  
M2J = 100 - 240V AC / cáp  
M2T = 100 - 240V AC / khối terminal\*

③ Còi  
Trống = Không còi  
B = Có còi\*

④ Màu sắc  
R = Đỏ, Y = Vàng cam  
G = Xanh lục, B = Xanh dương

\* SKH: Chỉ với Φ100mm

## Thông số kỹ thuật

Transistors được hỗ trợ

Không

Âm báo động

Giai điệu đơn(peak)

Điều khiển âm lượng

Không

## Product List

Model	Size (mm)	Rated Voltage	Wiring	Alarm	Luminous Color	Power Consumption	Mass
SKS-M1J-R/Y/G/B	Φ80	12 - 24V DC	Cable	None	Red/ Amber/Green/Blue	2.9W	0.24kg
SKS-M2J-R/Y/G/B	Φ80	100 - 240V AC	Cable	None	Red/ Amber/Green/Blue	3.0W	0.27kg
SKH-M1J-R/Y/G/B	Φ100	12 - 24V DC	Cable	None	Red/ Amber/Green/Blue	2.9W	0.33kg
SKH-M1J-B-R/Y/G/B	Φ100	12 - 24V DC	Cable	Yes	Red/ Amber/Green/Blue	3.6W	0.34kg
SKH-M1T-R/Y/G/B	Φ100	12 - 24V DC	Push-in terminal block	None	Red/ Amber/Green/Blue	2.9W	0.30kg
SKH-M1TB-R/Y/G/B	Φ100	12 - 24V DC	Push-in terminal block	Yes	Red/ Amber/Green/Blue	3.6W	0.31kg
SKH-M2J-R/Y/G/B	Φ100	100 - 240V AC	Cable	None	Red/ Amber/Green/Blue	3.0W	0.36kg
SKH-M2B-R/Y/G/B	Φ100	100 - 240V AC	Cable	Yes	Red/ Amber/Green/Blue	3.3W	0.37kg
SKH-M2T-R/Y/G/B	Φ100	100 - 240V AC	Push-in terminal block	None	Red/ Amber/Green/Blue	3.0W	0.33kg
SKH-M2TB-R/Y/G/B	Φ100	100 - 240V AC	Push-in terminal block	Yes	Red/ Amber/Green/Blue	3.3W	0.34kg
SKP-M1J-R/Y/G/B	Φ150	12 - 24V DC	Cable	None	Red/ Amber/Green/Blue	2.9W	0.67kg
SKP-M2J-R/Y/G/B	Φ150	100 - 240V AC	Cable	None	Red/ Amber/Green/Blue	3.0W	0.70kg

## Optional Parts

For details refer to P. 93 to P. 98

Product Description	Model Number
Wall mounting waterproof bracket	SZK-101
Wall mount bracket	SZK-102
Wall mount bracket	SZK-103
Cover for wall mount bracket	SZK-104
Cover for wall mount bracket	SZK-105
Wall mount bracket	SZ-007
Wall mount bracket	SZ-008
Wall mount bracket	SZ-023
Ceiling mounting bracket	SZW-101

Product Description	Model Number
Mounting rubber gasket	SZW-102
Mounting rubber gasket	SZW-103
Pole mounting bracket	SZP-101
1/2 in. NPT Bracket	SZP-102
1/2 in. NPT Bracket	SZP-103
1/2 in. NPT Bracket	SZP-104

## Dimensions (mm)

SKSM ☒ ☒

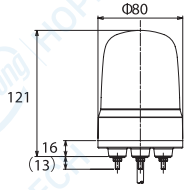

SKH-M ☒ -☒

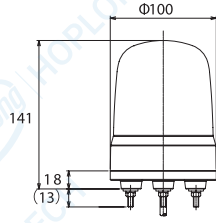

SKHM ☒ B-☒

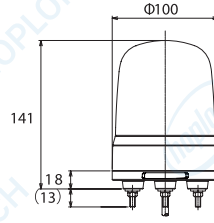

SKPM ☒ ☒

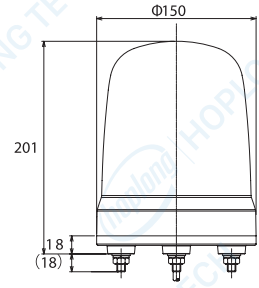

## Mounting Dimensional Drawing(mm)

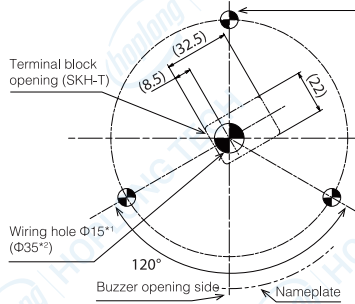

Mounting Holes (3 places)		Nut (Included)
SKS	Φ5	M4
SKH	Φ6	M5
SKP	Φ9	M8

Mounting Pitch	
SKS	Φ50
SKH	Φ70
SKP	Φ120

Model	Nut	Recommended Tightening Torque
SKS	M4	0.7 N·m
SKH	M5	1.4 N·m
SKP	M8	6.0 N·m

- \* 1 Adjust hole size as needed.
- \* 2 Cord specifications with AC power plug